

Link-Belt 2800

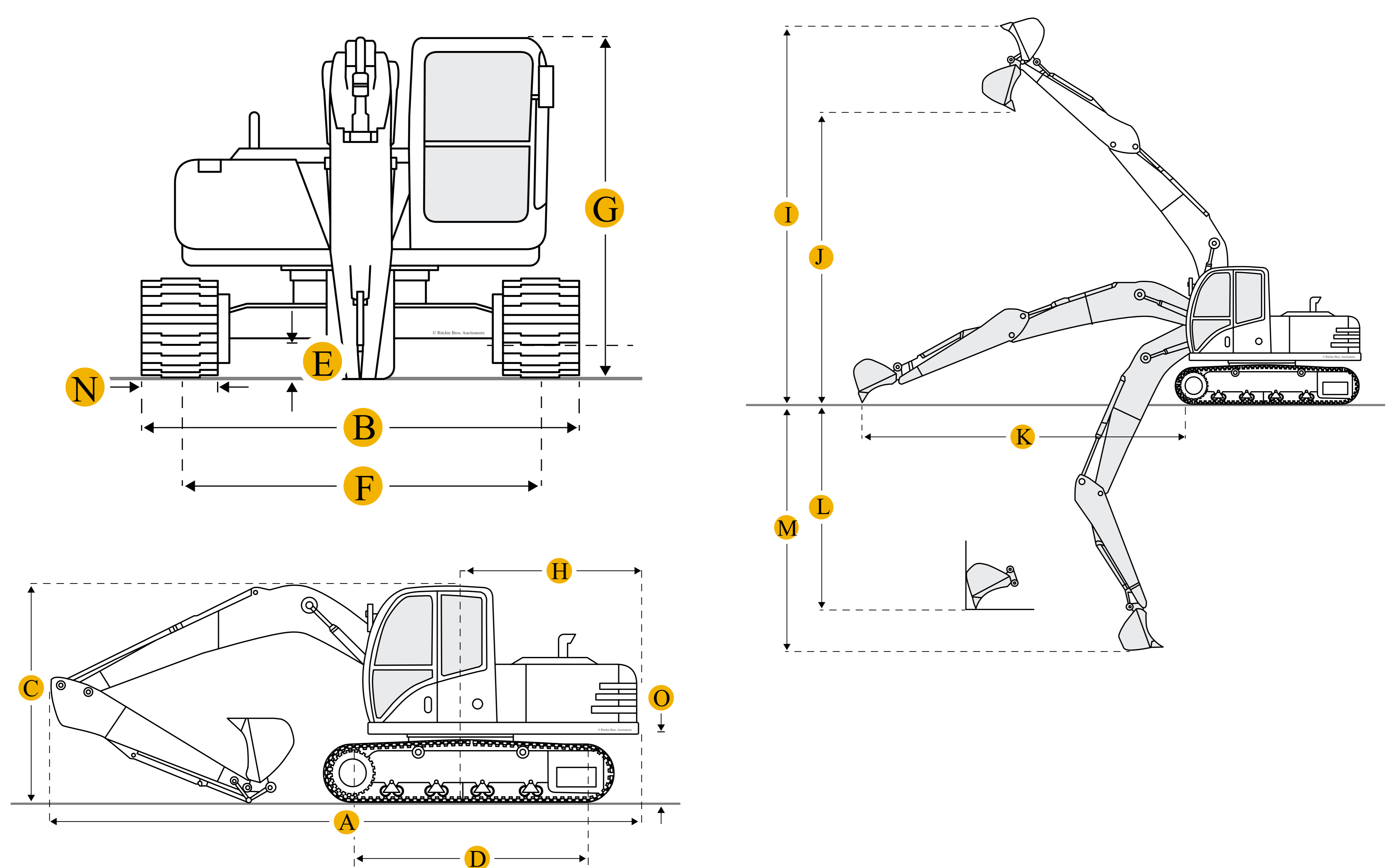

Units

Dimensions

Boom/Stick Option (Hex) 1

A Shipping Length Of Unit	9560 mm
C Shipping Height Of Unit	3060 mm
I Max Cutting Height	9260 mm
J Max Loading Height	6460 mm
K Max Reach Along Ground	9240 mm
L Max Vertical Wall Digging Depth	5470 mm
M Max Digging Depth	6100 mm

Boom/Stick Option (Hex) 1

Boom 18\8" (5700mm) / Stick 7\11" (2400mm)

Boom/Stick Option (Hex) 2

A Shipping Length Of Unit	9440 mm
I Max Cutting Height	9470 mm
C Shipping Height Of Unit	2930 mm
J Max Loading Height	6670 mm
K Max Reach Along Ground	9780 mm
L Max Vertical Wall Digging Depth	6070 mm
M Max Digging Depth	6690 mm

Boom/Stick Option (Hex) 2

Boom 18\8" (5700mm) / Stick 9\10" (3000mm)

Dimensions

E Ground Clearance	460 mm
G Height To Top Of Cab	2930 mm
B Width To Outside Of Tracks	3190 mm
D Length Of Track On Ground	3660 mm
H Tail Swing Radius	2770 mm

Removal Counterweight Clearance

1040 mm

Undercarriage

F Track Gauge	2390 mm
N Shoe Size	800 mm
Ground Pressure	32.34 kPa
Number Of Shoes Per Side	49
Number Of Carrier Rollers Per Side	2
Max Travel Speed	5.48 km/h
Number Of Track Rollers Per Side	8

Specifications

Engine

Number Of Cylinders	6
Engine Make	2353
Engine Model	6BG1T
Net Power	95.5 kw
Power Measured @	1900 rpm
Max Torque	463.7 Nm
Displacement	6.5 L
Aspiration	Turbocharged
Torque Measured @	1600 rpm

Operational

Operating Weight	20547.8 kg
Fuel Capacity	310 L
Cooling System Fluid Capacity	25.5 L
Hydraulic System Fluid Capacity	200 L
Operating Voltage	24 V
Engine Oil Capacity	19.5 L
Swing Drive Fluid Capacity	5 L
Alternator Supplied Amperage	40 amps
Hydraulic System Relief Valve Pressure	34335.9 kPa
Hydraulic Pump Flow Capacity	393.7 L/min

Swing Mechanism

Swing Speed	11.9 rpm
Swing Torque	60740.7 Nm

Buckets

Reference Bucket Capacity	0.8 m ³
Minimum Bucket Capacity	0.4 m ³
Maximum Bucket Capacity	1.2 m ³