

# Case CX330 CL

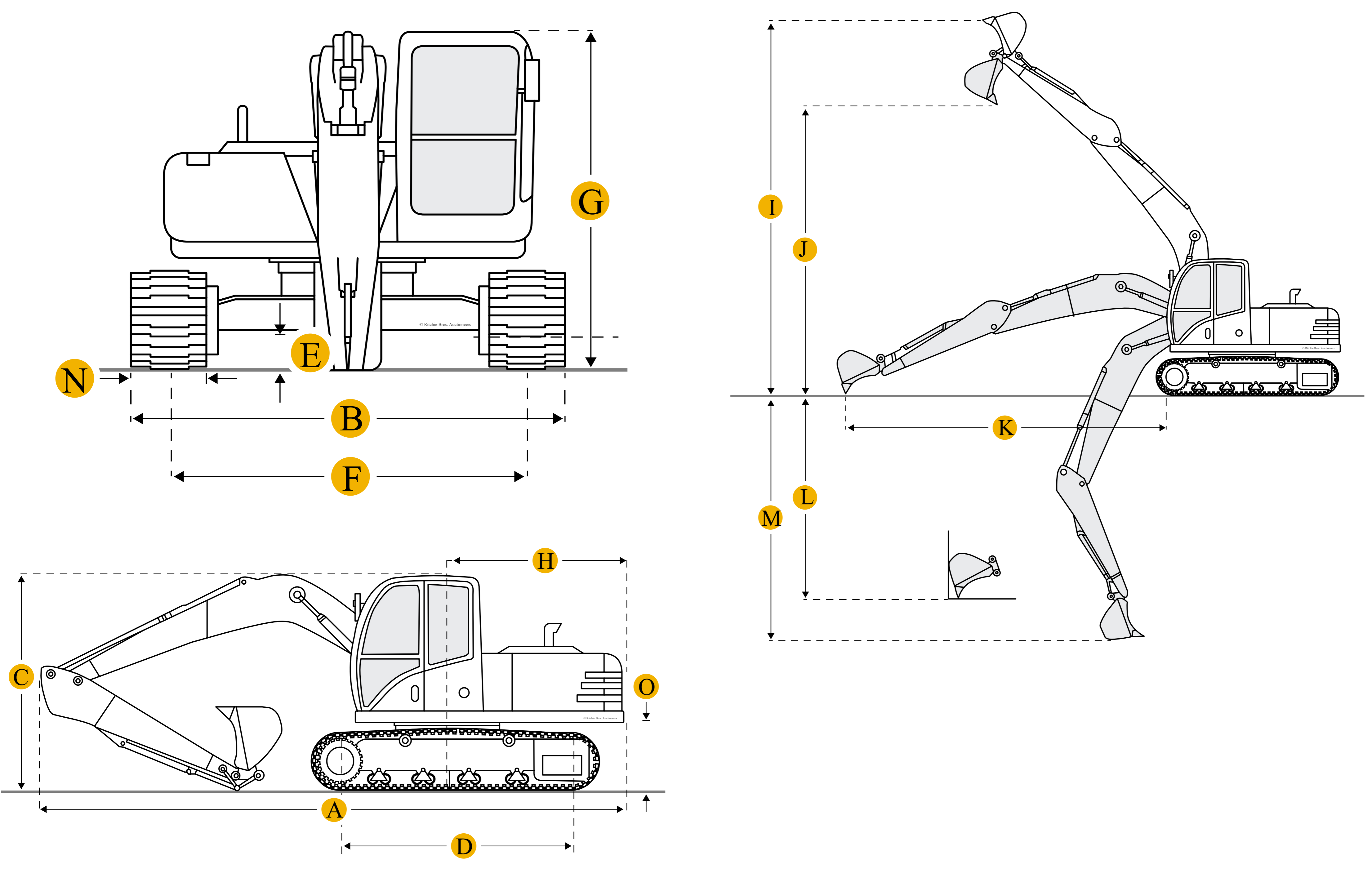

Units

## Dimensions

|   |  |
|---|--|
| Boom/Stick Option (Hex) 1                     |  |
| <b>A</b> Shipping Length Of Unit              | 11090 mm                                   |
| <b>C</b> Shipping Height Of Unit              | 3510 mm                                    |
| <b>I</b> Max Cutting Height                   | 10670 mm                                   |
| <b>J</b> Max Loading Height                   | 7540 mm                                    |
| <b>K</b> Max Reach Along Ground               | 11720 mm                                   |
| <b>L</b> Max Vertical Wall Digging Depth      | 7150 mm                                    |
| <b>M</b> Max Digging Depth                    | 8140 mm                                    |
| <b>Boom/Stick Option (Hex) 1</b>              | Boom 21'2" (6450mm)/ Stick 13'3" (4040 mm) |
| Boom/Stick Option (Hex) 2                     |  |
| <b>A</b> Shipping Length Of Unit              | 11050 mm                                   |
| <b>I</b> Max Cutting Height                   | 10370 mm                                   |
| <b>C</b> Shipping Height Of Unit              | 3290 mm                                    |
| <b>J</b> Max Loading Height                   | 7230 mm                                    |
| <b>K</b> Max Reach Along Ground               | 10980 mm                                   |
| <b>L</b> Max Vertical Wall Digging Depth      | 6350 mm                                    |
| <b>M</b> Max Digging Depth                    | 7340 mm                                    |
| <b>Boom/Stick Option (Hex) 2</b>              | Boom 21'2" (6450mm)/ Stick 10'8" (3250 mm) |
| Boom/Stick Option (Hex) 3                     |  |
| <b>A</b> Shipping Length Of Unit              | 11130 mm                                   |
| <b>I</b> Max Cutting Height                   | 10320 mm                                   |
| <b>J</b> Max Loading Height                   | 7140 mm                                    |
| <b>C</b> Shipping Height Of Unit              | 3530 mm                                    |
| <b>K</b> Max Reach Along Ground               | 10470 mm                                   |
| <b>L</b> Max Vertical Wall Digging Depth      | 5970 mm                                    |
| <b>M</b> Max Digging Depth                    | 6730 mm                                    |
| <b>Boom/Stick Option (Hex) 3</b>              | Boom 21'2" (6450mm)/ Stick 8'8" (2630 mm)  |
| Dimensions                                    |  |
| <b>E</b> Ground Clearance                     | 480 mm                                     |
| <b>G</b> Height To Top Of Cab                 | 3070 mm                                    |
| <b>B</b> Width To Outside Of Tracks           | 3400 mm                                    |
| <b>D</b> Length Of Track On Ground            | 4040 mm                                    |
| <b>H</b> Tail Swing Radius                    | 3450 mm                                    |
| <b>Removal Counterweight Clearance</b>        | 1210 mm                                    |
| Undercarriage                                 |  |
| <b>F</b> Track Gauge                          | 2590 mm                                    |
| <b>N</b> Shoe Size                            | 800 mm                                     |
| <b>Max Travel Speed</b>                       | 5.5 km/h                                   |
| <b>Ground Pressure</b>                        | 51.03 kPa                                  |
| <b>Number Of Shoes Per Side</b>               | 48   |
| <b>Number Of Carrier Rollers Per Side</b>     | 2  |
| <b>Number Of Track Rollers Per Side</b>       | 8  |
| <b>Drawbar Pull</b>                           | 271 kN                                     |
| Specifications                                |  |
| Engine  |  |
| <b>Number Of Cylinders</b>                    | 6  |
| <b>Engine Make</b>                            | 2353                                       |
| <b>Engine Model</b>                           | AH-6HKIX, Tier III certified               |
| <b>Net Power</b>                              | 185 kw                                     |
| <b>Power Measured @</b>                       | 2000 rpm                                   |
| <b>Max Torque</b>                             | 1079.3 Nm                                  |
| <b>Displacement</b>                           | 7.8 L                                      |
| <b>Aspiration</b>                             | turbocharged                               |
| <b>Torque Measured @</b>                      | 1500 rpm                                   |
| Operational                                   |  |
| <b>Operating Weight</b>                       | 35400 kg                                   |
| <b>Fuel Capacity</b>                          | 580 L                                      |
| <b>Cooling System Fluid Capacity</b>          | 30 L                                       |
| <b>Hydraulic System Fluid Capacity</b>        | 350 L                                      |
| <b>Operating Voltage</b>                      | 24 V                                       |
| <b>Engine Oil Capacity</b>                    | 36 L                                       |
| <b>Swing Drive Fluid Capacity</b>             | 6 L  |
| <b>Alternator Supplied Amperage</b>           | 50 amps                                    |
| <b>Hydraulic System Relief Valve Pressure</b> | 34301.4 kPa                                |
| <b>Hydraulic Pump Flow Capacity</b>           | 568 L/min                                  |
| Swing Mechanism                               |  |
| <b>Swing Speed</b>                            | 9.6 rpm                                    |
| Buckets                                       |  |
| <b>Reference Bucket Capacity</b>              | 1.6 m3                                     |
| <b>Minimum Bucket Capacity</b>                | 1 m3                                       |
| <b>Maximum Bucket Capacity</b>                | 2.3 m3                                     |